

# GNV-102

## Sound Level Calibrator

### Class 2

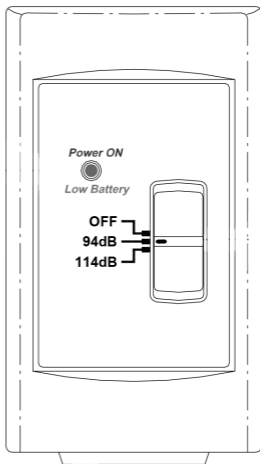

## Table of Contents

Safety.....	2
Compliance and Certifications.....	3
Features.....	4
Specifications.....	4
Instrument Description.....	5
Operating Instructions.....	6
Warranty.....	7
Service.....	8

© 2018 Global Specialties (a brand of Cal Test Electronics). All rights reserved.

Unauthorized duplication of Global Specialties documentation materials is strictly prohibited. Customers are permitted to duplicate and distribute Global documentation for internal educational purposes only.

## **Safety**

To avoid personal injury and/or product damage, review and comply with the following safety precautions. These precautions apply to both operating and maintenance personnel and must be followed during all phases of operation, service, and repair of this probe.

### ***Dry Conditions***

Hands, shoes, floor, and work bench must be dry. Avoid making measurements under humidity, dampness, or other environmental conditions that might affect safety.

### ***Cleaning***

Use a soft cotton cloth lightly moistened with a mild solution of detergent and water. Do not allow any portion to be submerged at any time. Dry thoroughly before attempting to make voltage measurements. Do not use solvents or expose to solvent fumes as they may cause deterioration or damage

### ***Do not operate:***

- In the presence of noxious, corrosive, flammable fumes, gases, vapors, chemicals, or finely-divided particulates.
- In environments where there is a danger of any liquid being spilled on the probe.
- In air temperatures exceeding the specified operating temperatures.
- In atmospheric pressures outside the specified altitude limits or where the surrounding gas is not air.

## **Compliance and Certifications**

### ***CE Compliance***

This product meets the essential requirements of the applicable European Directives as follows:

- 2014/30/EU: Electromagnetic Directive (EMC)
- 2011/65/EU: Restriction of Hazardous Substances Directive (RoHS)

### ***Safety***

This product meets the follow standard(s) of safety for electrical equipment for measurement, control and laboratory use:

- IEC/EN 60942-1

### ***Disposal***

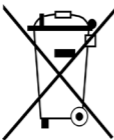

(Applicable in the European Union and other European countries with separate collection systems). This product is subject to Directive 2012/19/EU of the European Parliament and the Council of the European Union on waste electrical and electronic equipment (WEEE), and in jurisdictions adopting that Directive, is marked as being put on the market after August 13, 2005, and should not be disposed of as unsorted municipal waste. Please utilize your local WEEE collection facilities in the disposition of this product

## Features

- Capable of calibrating 1/2 inch and 1 inch microphones
- Conforms to IEC 60942 Class 2
- Calibrates at 94 dB and 114 dB

## Specifications

Operating Limits and Functions	
Measuring Level Ranges	94 dB at 20 uPa
	114 dB at 20 uPa
Output Frequency	1000 Hz $\pm$ 2 %
Accuracy	$\pm$ 0.5 dB
Total Harmonic Distortion	<3%
Reference Conditions	
Temperature	23 °C (74 °F)
Relative Humidity	50 %
Atmospheric Pressure	1013 hPa
Influence of Ambient Conditions	
Temperature Coefficient	0.005 dB / °C
Humidity Coefficient	0.005 dB / % Relative humidity
Environmental Specifications	
Operating Temperature	0 to 40 °C (32 to 104 °F)
Operating Humidity	10 to 90% Relative humidity
Storage Temperature	-10 to 50 °C (14 to 122 °F)
Storage Humidity	0 to 70% Relative humidity
Pressure	650 - 1080 hPa
Mechanical and Electrical Specifications	
Power	One 9V battery: 006P, IEC 6F22, NEDA 1604
Battery Life	Approx. 40 hours
Dimensions	113 x 63 x 44 mm (4.4 x 2.4 x 1.7")
Weight	Approx. 170g (8.6 oz)

## Instrument Description

1. Power and low battery LED indicator
2. Power and output level switch
3. 1 inch calibration slot
4. 1/2 inch calibration slot adapter
5. Battery cover and compartment

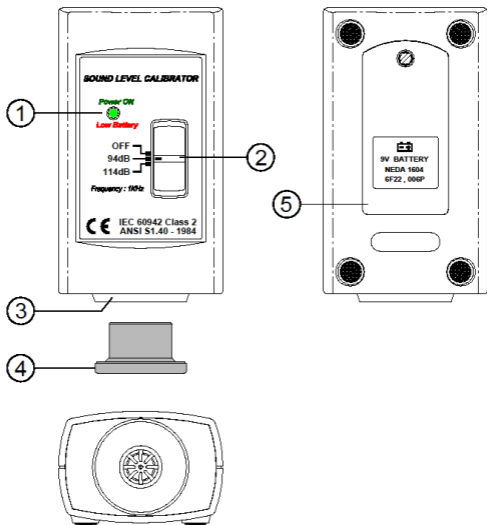

# Operating Instructions

## Power

1. Remove the battery cover and install a 9V battery in the battery compartment
2. Slide the switch from off to 94 dB or 114 dB

If the LED shines green, the device is ready to be used. If the LED shines red, the battery needs to be replaced.

## Calibration Procedure

The instrument may be calibrated on the Fast or Slow setting, as well as either A or C weighting.

1. The calibration slot will accommodate either a 1 or 1/2 inch sound level meter
2. Place the tip of the sound level meter into the calibration slot as depicted below and hold the devices still
3. Set the range on the sound level meter to the appropriate value for calibration at 94 dB or 114 dB
4. Adjust the sound level meter until it matches the selected calibration volume

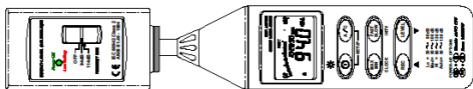

## Limited One-Year Warranty

Global Specialties warrants these products to be free from defective material or workmanship for a period of 1 year from the date of original purchase. Under this warranty, Global Specialties is limited to repairing the defective device when returned to the factory, shipping charges prepaid, within the warranty period.

Units returned to Global Specialties that have been subject to abuse, misuse, damage, or accident, or have been connected, installed, or adjusted contrary to the instructions furnished by Global Specialties, or that have been repaired by unauthorized persons, will not be covered by this warranty.

Global Specialties reserves the right to discontinue models, change specifications, price, or design of this device at any time without notice and without incurring any obligation whatsoever.

The purchaser agrees to assume all liabilities for any damages and/or bodily injury which may result from the use or misuse of this device by the purchaser, his employees, or agents.

This warranty is in lieu of all other representations or warranties expressed or implied and no agent or representative of Global Specialties is authorized to assume any other obligation in connection with the sale and purchase of this device.



## Service

If you have a need for calibration or repair services, technical, or sales support, please contact us:

Global Specialties  
22820 Savi Ranch Parkway Yorba Linda, CA 92887  
800-572-1028 or 714-221-9330  
[globalspecialties.com](http://globalspecialties.com)

## Notes:

**Notes:**

